

TECHNICAL DATASHEET



END CAP

03 Update - 05/2022

TECHNICAL DATA

| | |
|------------------------|-------------------|
| Article No | 001 117 0140 0110 |
| d (mm) | 110 |
| le (mm) | 85 |
| s (mm) | 10,0 |
| Weight (Kg) | 0,350 |
| Box Quantity (pcs) | 45 |
| Box Dimension (pcs) | 55x30x36 |

INJECTION MOULDED

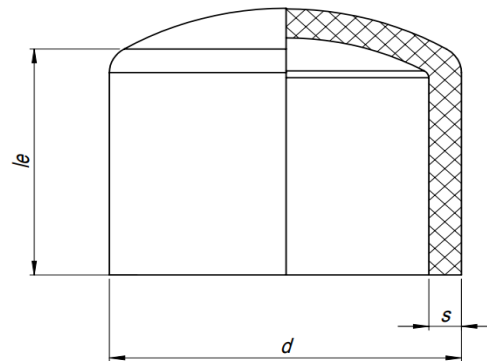

IDENTIFICATION OF PRODUCT

| | |
|----------------|---|
| D(mm) | 110 |
| SDR | 11 |
| RAW METARIAL | PE 100 |
| PRESSURE CLASS | 16 Bar Water 10 Bar Gas |
| TRADEMARK | NTG |
| EXECUTION | Injection Moulded |
| STANDARD | EN 12201-3 EN 1555-3 AS /NZS 4129 |

SPECIFICATION

Long Spigot

Tolerance on diameters and thickness according to the standards. The other dimensions are specialized. Tolerance $\pm 5\%$. NTG PLASTIK reserves all the right to change any information without giving prior notice. The production, distribution and utilization of this document without explicit authorization is prohibited.

Fr 161 Rev 00